

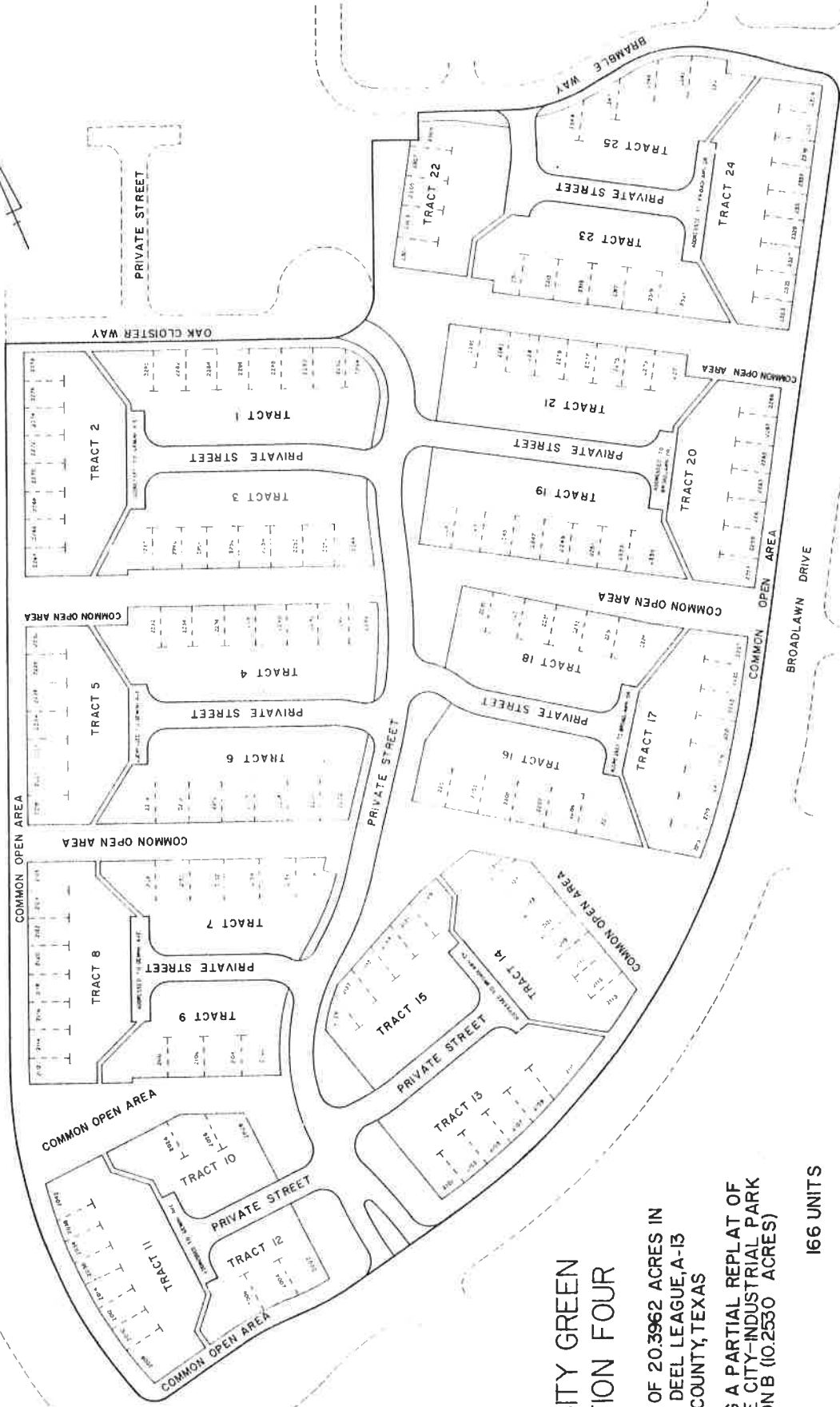

GEMINI AVENUE



UNIVERSITY GREEN  
SECTION FOUR

A SUBDIVISION OF 20.3962 ACRES IN  
THE SARAH DEEL LEAGUE, A-13  
HARRIS COUNTY, TEXAS

ALSO BEING A PARTIAL REPLAT OF  
CLEAR LAKE CITY-INDUSTRIAL PARK  
SECTION B (10.2530 ACRES)

25 TRACTS 166 UNITS

