

National Park Service
U.S. Department of the Interior

Rivers, Trails, and Conservation Assistance Program



Shiawassee River Heritage Water Trail and The National Water Trail Program

Barbara Nelson-Jameson

Empire, MI

231.334.3130

Barbara_Nelson-Jameson@nps.gov



Rivers, Trails, and Conservation Assistance Program



With our Partners:

- Protect 1,000 miles of river
- Create over 2,000 miles of trails
- Conserve more than 70,000 acres of open space



Shiawassee River Water Trail....

- ✓ Essential Elements
- ✓ Variety of Water Trails
- ✓ National Water Trails Program
- ✓ Michigan Water Trail Efforts
- ✓ Best Management Practices -Shiawassee River WT



PA Water Trails Program Report



"Water Trails? Oh yeah, we used to call those rivers!"

~The water is already there. But what makes a river into a water trail?

The Water Trails are defined as...

- Recreational routes on waterways
- With a network of public access points
- Supported by broad based community partnerships
- Provide both conservation and recreation opportunities

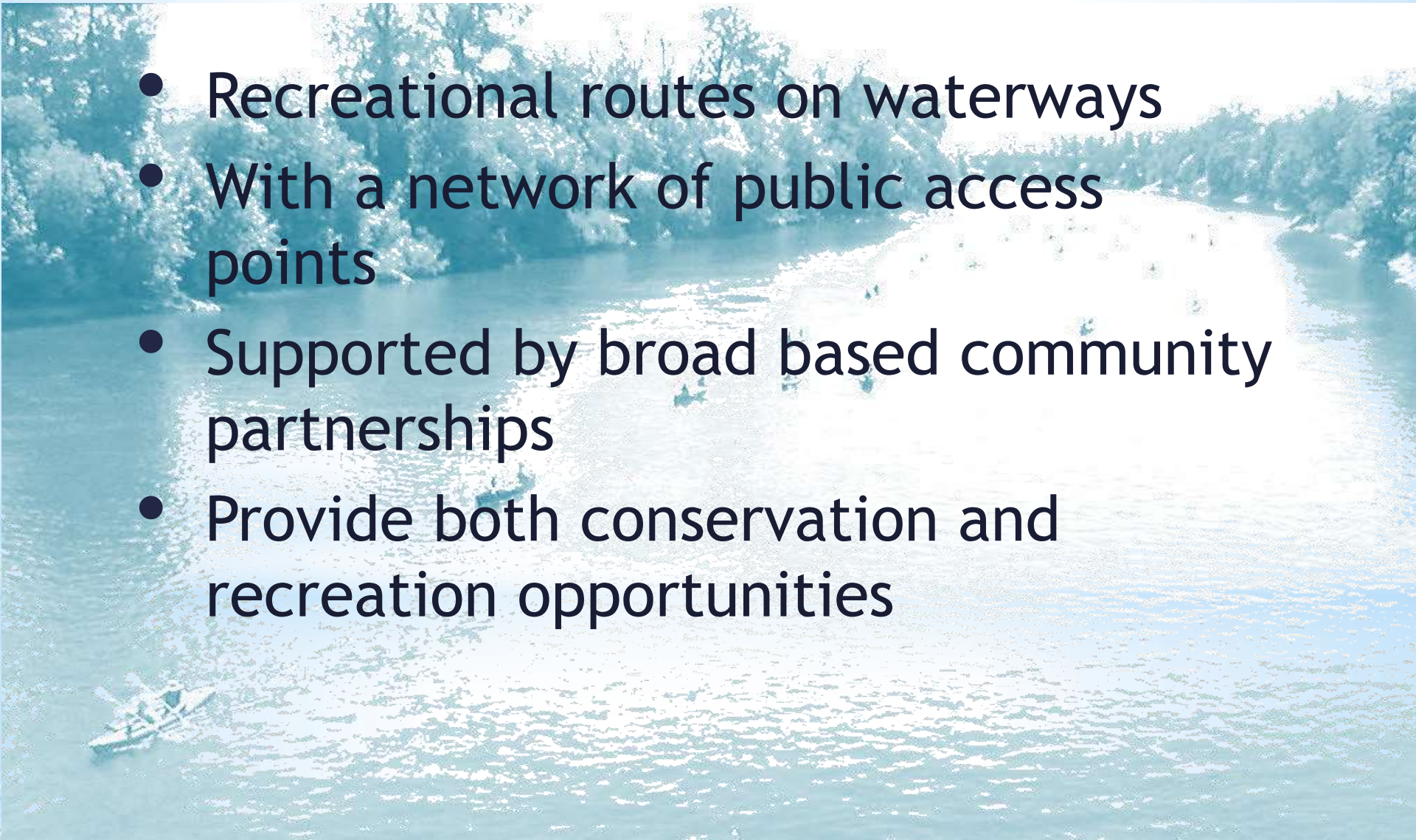

Every water trail must have:



- ☐ A local managing organization to care about and manage the trail.
- ☐ Support by the local community and local government.
- ☐ A minimum level of public access to support a trail experience.
- ☐ Public information provided online or in print to market the trail to potential trail users, to help them find the trail, plan their trip, use the trail safely, and learn about the natural/cultural resources

Historic Water Trails



Captain John Smith Chesapeake
National Historic Trail

 [My Adventure Planner](#) ▶

[Home](#) [The Chesapeake](#) [Native Americans](#) [Captain John Smith](#) [Visit the Trail](#) [Things to Do](#) [Blog](#) [About the Trail](#)



Join
THE ADVENTURE.

▶ VISIT THE TRAIL



The Past and the Present
CHESAPEAKE BAY ▶



The Past and the Present
AMERICAN INDIANS ▶



Learn About the Voyages of
CAPTAIN JOHN SMITH ▶

Wilderness Water Trails

Paddle an historic 740-mile waterway through New York, Vermont, New Hampshire, Québec and Maine!



Long Distance Water Trails



Lake Michigan Water Trail - 1600 miles

760 miles Michigan Shoreline



Urban Water Trails

62% of kayaking occurs within an hour's drive of home



Inland Waterways

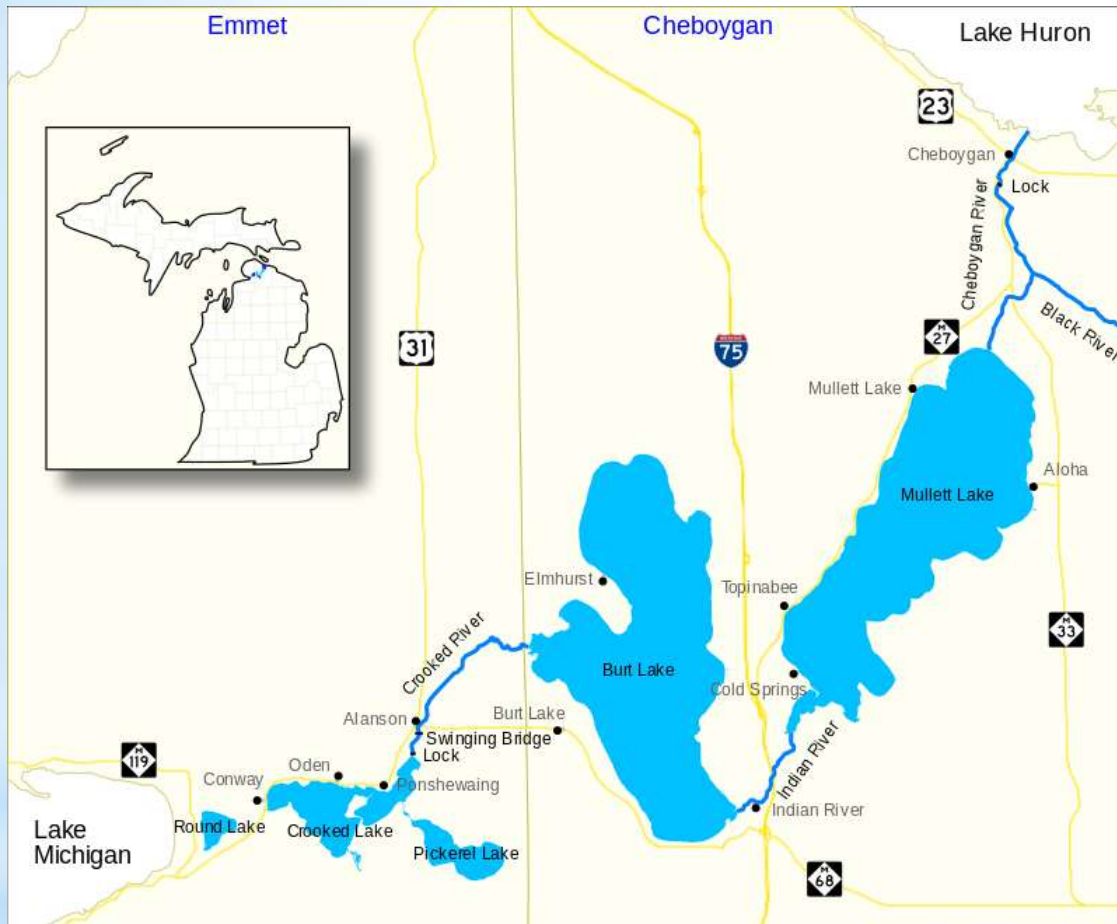

Participation in canoeing has grown from 7% to 10%, participation in rafting has doubled from 4% to 8% and participation has grown across all kayaking segments at roughly the same rate.

Paddle Sports Participation (2009-2012)

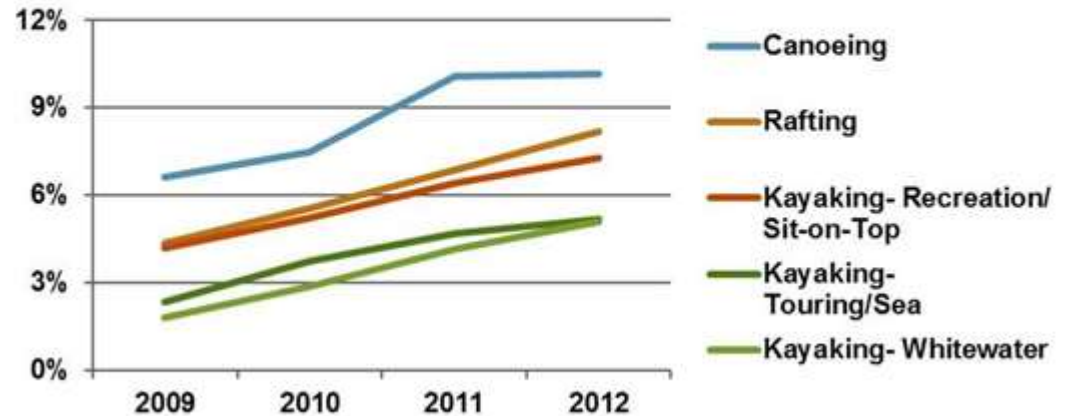

Kayaking has enjoyed steady growth since 2006

<http://www.outdoorfoundation.org/research>



National RTCA Water Trail Projects

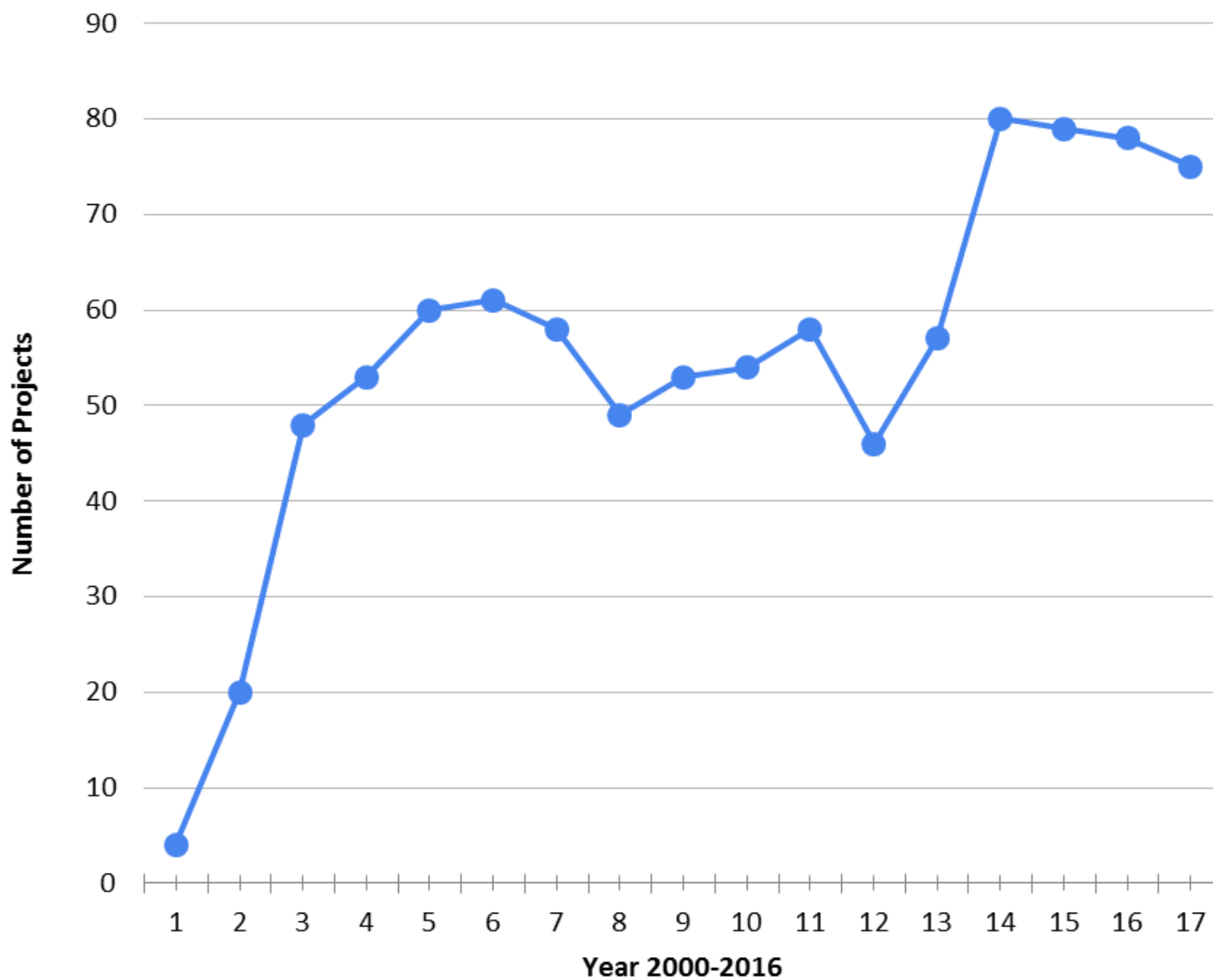

Estimated Annual Impact of all Paddlers in the Midwest

Participants	4.6 million
Trip Related Spending	\$1.78 billion
Gear Related Spending	\$433 million
Total Tax Revenue	\$396 million
Jobs Supported	34,999





NATIONAL WATER TRAILS SYSTEM

Celebrating:

- 18 national water trails
- 2,674.2 miles of trail
- 18 States

Island Loop Trail, Port Huron - 11 miles
Huron River Water Trail - SE MI - 104 miles



National Water Trails System has been established to:



- **Protect and restore America's rivers, shorelines, and waterways and conserve natural areas along waterways**
- **Increase access to outdoor recreation on shorelines and waterways**



Who Designates Them?

- Designated by the Secretary of the Interior or the Secretary of Agriculture
- Recognized as part of the National Trails System

Who Manages Them?

- Managed by a local management entity (local, state, or federal government agency; nonprofit organization; interagency organization)

Criteria for National Recreation Trails



- The trail (and its access points) must be **open to public use** and be **designed, constructed, and maintained** according to best management practices, in keeping with the anticipated use.
- The trail is **in compliance** with applicable land use plans and environmental laws.
- The trail will be **open for public use** for at least 10 consecutive years after designation.
- The trail designation must be **supported by the landowner(s)**, (public or private), on which access points exist.



NATIONAL WATER TRAILS SYSTEM

Best Management Practice Category: Recreation Opportunities



Recreation
Opportunities



Education



Conservation



Community
Support



Public
Information



Trail
Maintenance



Planning



Mapping
toolbox

Definition:

The water trail route has established public access points that accommodate a diversity of trip lengths and provide access to a variety of opportunities for recreation and education.

Launches and Access
Sites



Prepare to Launch! Guidelines for Assessing, Designing, and Building Launch Sites for Carry-in Watercraft is a resource designed to help river and water trail managers and park planners build 'put-in and take out' sites as they address the evolving needs of paddlers and other users.

Connectivity

How well the water trail connects with other water trails, land recreation networks, and public transportation networks including sidewalks, bike trails, bus routes, etc.

Bronx River Blueway
NRT Map



Map of Access points along the water trail showing street grid.

Online Interactive Map

The Mississippi National River and Recreation Area has created an online interactive map to integrate the water trail into the regional transportation networks. The map shows bikeshare stations, bike routes, bus stops, rail stations, and streets.

<http://rivertripplanner.org/>

NATIONAL WATER TRAILS SYSTEM



A distinctive national network of exemplary water trails which are designated by the Secretary of the Interior. The trails within the National Water Trails System are cooperatively supported and sustained.

Island Loop Trail	11 miles (Port Huron, MI)
Huron River	104 miles (Ann Arbor, MI)
Kitsap Peninsula	371 miles (Seattle, WA)
Black Canyon	30 miles (AZ, NV)
Bayou Teche	131 miles (LA)
Chattahoochee River NRA	48 miles (Atlanta, GA)
Mississippi River NRA	76 miles (Minneapolis, MN)
Bronx River Greenway	8 miles (New York, NY)
Willamette River Water Trail	216 miles (Oregon)
Hudson River Water Trail	256 miles (New York)
Mississippi / Great River WT	121 miles (St. Louis, MS)
Okefenokee NWR	120 miles (Georgia)
Alabama Scenic River Trail	631 miles (Alabama)
Kansas River Water Trail	173 miles (Kansas City, KS)
Rock River Water Trail	330 miles (Quad Cities, IL)
Waccamaw River Blue Trail	100 miles (South Carolina)



2015 Michigan National Water Trails Forum

0:00 / 14:50

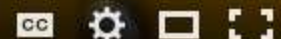

National Water Trails Forum 2015



UpNorth TV



+ Add to < Share ... More

Coordinating Organizations

- National Park Service
- River Network
- River Management Society
- Huron River Water Trail
- St. Clair County
- Michigan Sea Grant
- Riverside Kayak Connection

36 views



Port Huron - Island Loop Water Trail



**Michigan has 63 navigable rivers
3,288 mi. of shoreline**





Michigan Snowmobile and Trail Advisory Council
Michigan Comprehensive Trail Plan
www.michigan.gov/trailplan
May 2013



Michigan's Water Trails



Michigan Department of Natural Resources

Search

DNR CAMPING & RECREATION TRAILS AND PATHWAYS WATER TRAILS

DNR announces top 11 Michigan water trails, voted by the public

Michigan's TOP 11 Water Trails



Michigan DNR invited residents to vote for their favorite water trails via social media and an online voting contest, and the results are in! Here are the top 11 water trails as voted by the public, as well as a few honorable mentions. Michigan is home to fantastic paddling opportunities, so get out and explore some of these great water trails today!

1. [Au Sable River](#)
2. [Blueways of St. Clair](#)
3. [Chain of Lakes](#)
4. [Saginaw Bay Blueways](#)
5. [Huron River Water Trail](#)
6. [Inland Waterway](#)
7. [Shiawassee Heritage River Water Trail](#)
8. [Detroit Heritage River Water Trail](#)
9. [Lake Huron Blueways](#)
10. [Hiawatha Water Trail](#)
11. [Isle Royale National Park](#)

Go Now

Photo Michigan Sea Grant

Michigan is for paddlers!

Over 3,000 miles of trails on the Great Lakes, Inland Lakes, and Rivers await your canoe, kayak, or stand-up paddleboard!

Choose a region and prepare for your adventure!

www.michiganwatertrails.org







MID-MICHIGAN

[Go Now](#)

Show Places on the Map

Click an icon below to add or remove places on the map.

-  Access to River, Lake or Stream
-  Dam
-  Hide All Water Trails
-  Shiawassee River Water Trail



NATIONAL WATER TRAILS SYSTEM



A distinctive national network of exemplary water trails which are designated by the Secretary of the Interior. The trails within the National Water Trails System are cooperatively supported and sustained.

Best Management Practices

- Recreation
- Public Information
- Education
- Conservation
- Community Support
- Trail Maintenance
- Planning



BMP's Shiawassee River



Best Management Practices



recreation



Pine Steet Put In



recreation



Henderson Park Launch – New (2012) East Side Launch in construction and at low flow—preferred take-out for this park.



Harmon Patridge Park Launch (at very low flow)



Harmon Park Launch Sign



public information

Provide info for identifying access and trail routes; cultural, historic, and natural features; hazards and water quality.

The Huron River Water Trail:

- The Paddler's Companion features 28 waterproof maps
- Signage-distances btw access points
- Info Kiosks at launches & liveries
- QR Code to access online interpretive resources



public information

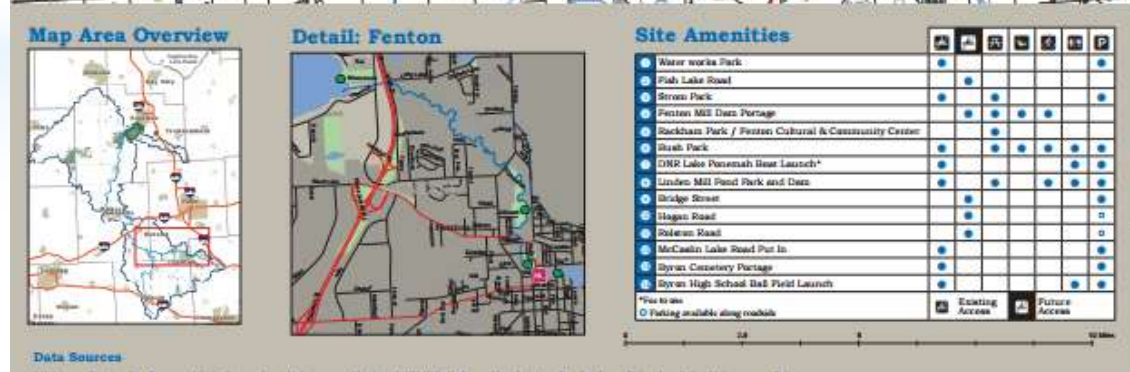
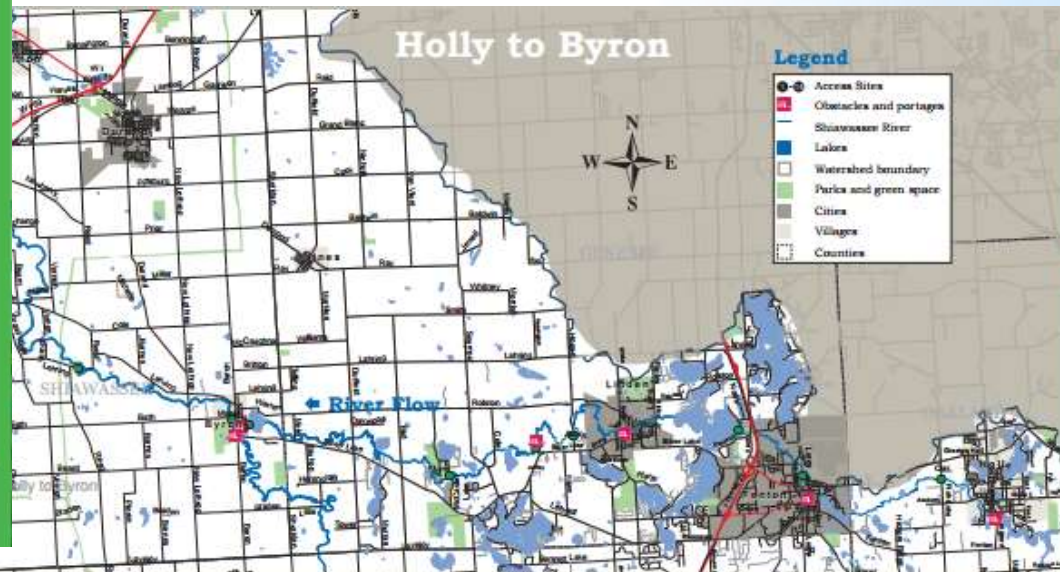
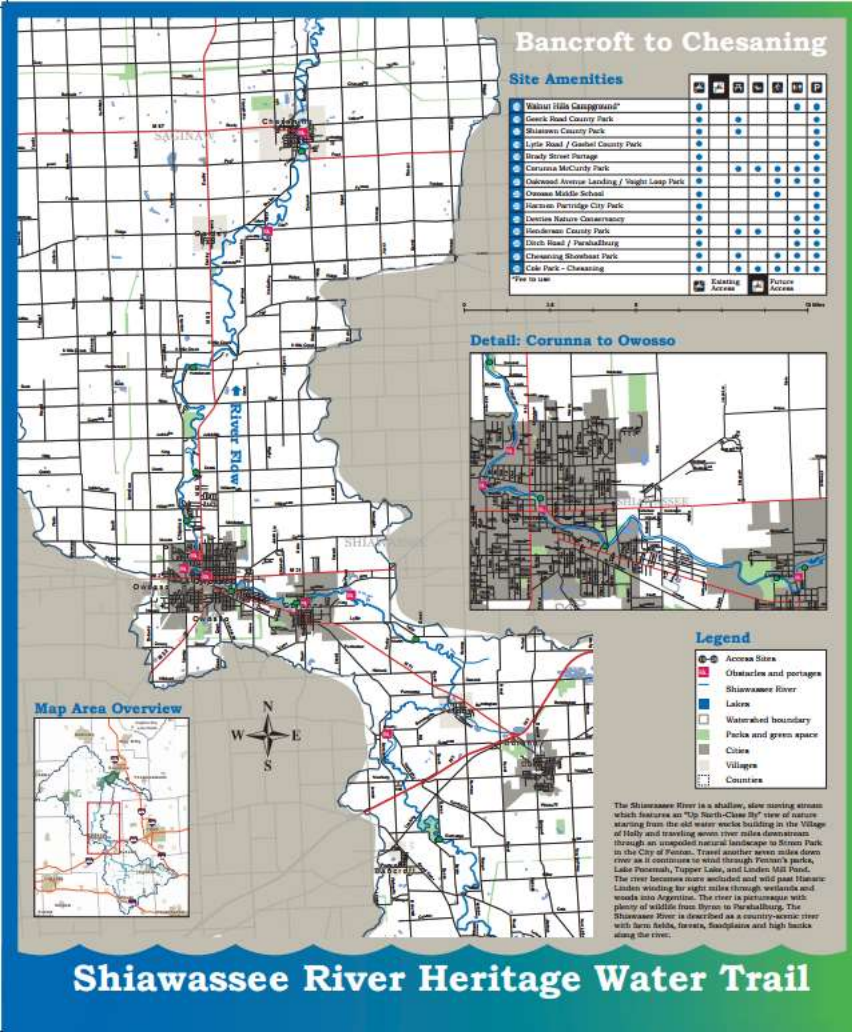

Shiawassee River Water Trail



Headwater Trail

Home

What's New

Proposed Trail Routes

Best Practices

Trail Supporters

Trail Resources

(1) Shiawassee River Heritage Water Trail

Click an image to enlarge



The Shiawassee River is a shallow, slow moving stream which features an "Up North-Close By" view of nature starting from the old water works building in the Village of Holly and traveling seven river miles downstream through an unspoiled natural landscape to Strom Park.

A sanctioned and safe canoe launch has been created in WaterWorks Park. A parking lot, pedestrian bridge, and nature lookout make the area accessible to all.

offers a diverse range of paddling experiences for of all abilities. It is considered a warm-water river with a low-moving current, very suitable for families in a canoe or kayak paddlers.

will enjoy the many twists and turns along the way. You can paddle upstream against the current a few miles back to the put-in for a good workout on the water. A car at the trip's end for a commute back to the start.

Add to Itinerary



Shiawassee River Water Trail

PURE MICHIGAN

PLAY STAY PLAN SHOP BLOG MAP

SEARCH

HOME > SHIOWASSEE RIVER HERITAGE WATER TRAIL

Shiawassee River Heritage Water Trail

ADD TO TRIP PLANNER

Headwaters Trails homepage

You can launch your canoe or kayak anytime from WaterWorks Park at 650 S. Broad Street in Holly and paddle to Strom Park on East Street in Ponton, seven river miles. This segment of the Shiawassee River is an adventure that takes about two and a half to three hours. The river here is shallow and slow moving but it has many twists and turns, an occasional beaver dam and changing scenery which add challenge and adventure to the paddling trip. The volunteer organization Headwaters Trails has added mile markers, interpretive signage, launch sites and trailhead parking. Restaurants and shopping beckon in the historic communities at each end of the river trail. Future development of this Heritage Water Trail will enable extended trips to the west through Ponton, Linden and Byron in Genesee County and then northward past Walnut Hills Campground and on to Owosso and Cheboygan along the way to Saginaw Bay, a total distance of 110 miles. At present there is no ferry serving this Pure Michigan adventure. Paddlers are requested to observe the "Leave No Trace" ethic, to share the resource with other river users and to take nothing but Good Memories.

116 3 9 3797

Information Map Weather

Headwaters Trails homepage

CONTACT INFORMATION

Address

550 S. Broad Street, Holly
PO Box 33
Holly, MI 48442

Diving Directions

Phone

(248) 834-3513

Email

sharon@pwmw.net

LISTEN

Headwaters Trails homepage

Although the U.S.C.A. makes reasonable efforts to maintain the accuracy of the web site content, it is not warranted to be error free. [Read more](#)

Hot Spots

Holland City

The Rinky Ford

Great Lakes Bay Region

Grand Rapids

Rain Arbor

Detroit

Pontiac

Gaylord

Iron River

St. Ignace

hill cranes can be at scoot across the

The Shiawassee River Canoe/Kayak Guide

February 20, 2015

Author: Phil Hathaway, Member—
Friends of the Shiawassee River

For Its Course Principally through Shiawassee County, Michigan



River View, Owosso, Mich.

Photo by Shariann Bergin-Hill

Signage



Along the Shiawassee



Learn Do There

Learn Do There is an Educational and Ethical program designed to assist outdoor enthusiasts in reducing their impact on nature. The following principles lead to responsible use and enjoyment of the outdoors:

- Plan ahead and prepare
- Dispose of waste properly
- Travel and pack on durable surfaces to reduce impact to natural areas
- Be considerate of others and protect the quality of their experience

Contact the *Learn Do There* program at 800-853-8100 or www.learn-dot.org

Paddling Safety

- Dams are hazardous and can be deadly. Learn to recognize them; not all are marked.
- Always portage around dams.
- Wear a properly fitted personal flotation device (PFD) - life jacket.
- Know your boat and your trip and paddle water appropriate to your skills.
- Check weather and conditions before you paddle - including relevant river flow levels.
- Never tell someone about your plans, including where you intend to kayak and what you expect to be back.
- Look out for and avoid possible hazards such as overhanging or submerged tree branches, a high volume of water, unpredictable currents, low water temperatures, and other craft.
- Talk to local landowners for information specific to the waterway you plan to paddle.



Shiawassee River Heritage Water Trail



Harmon Park Launch Sign



education

UWCA *Urban Wilderness Canoe Adventures*

HOME ABOUT US REGISTER GET INVOLVED SUPPORT UWCA CONTACT US



THE UWCA IS A
COLLABORATION OF:



Wilderness
Inquiry



MISSISSIPPI
River Fund

AND MANY OTHER
PARTNERS.



GREAT ADVENTURES IN YOUR BACKYARD.

1|2|3|4



The UWCA creates great adventures for youth, families, and adults on the Mississippi River. Join us for a day trip, overnight camping trip, or multi-day trip. It's an experience that will last a lifetime.



FOR YOUTH

The UWCA program is all about



FOR TEACHERS AND PARENTS



PADDLE THE RIVER

Come paddle one of our 24-foot



Stream Leaders
Volunteer Stream Monitoring



Streamside Fun for Families!

Stream Monitoring Day
Saturday, September 29, 9:00 - 11:00am

- ✦ Choose your stream - lots of sites to choose from
- ✦ No experience needed; we provide everything
- ✦ Meet your Leader at your stream and begin the hunt for bugs
- ✦ Bring your friends!



education



Through Stream Teams, river clean-up efforts, paddling events, educational programs, and more, the **Friends of the Shiawassee River** strives to partner with people just like you for continuous and positive actions that support a healthy watershed for everyone.

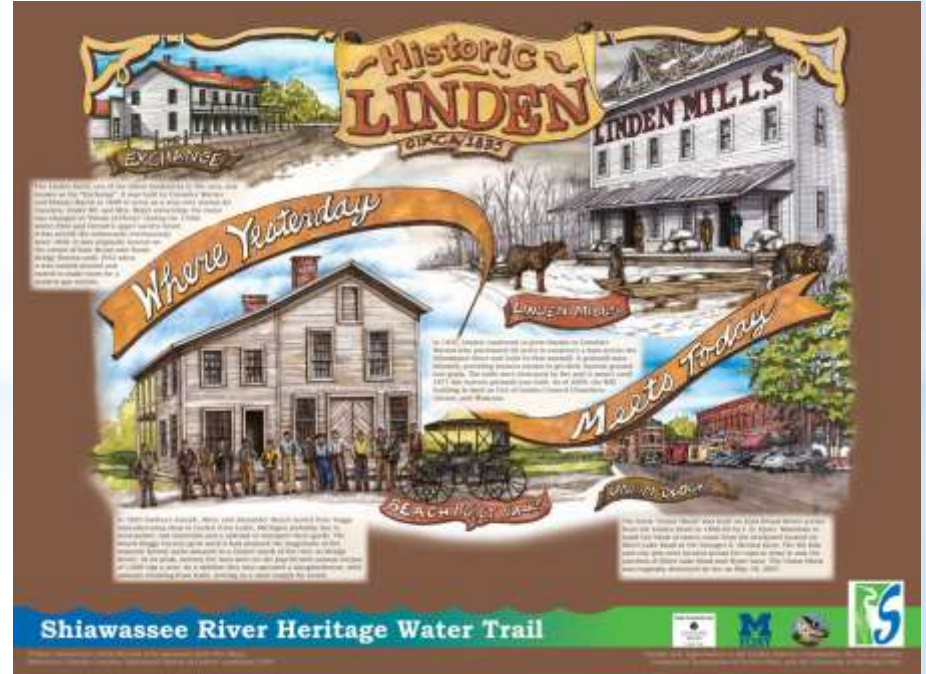



conservation



Cass River Clean Up



Bronx River Restoration



conservation



DAMS: QUESTIONS & ANSWERS

Q: DOES THE SHIAWASSEE RIVER NEED DAMS TO MAINTAIN GOOD OXYGEN LEVELS IN THE WATER?





community support

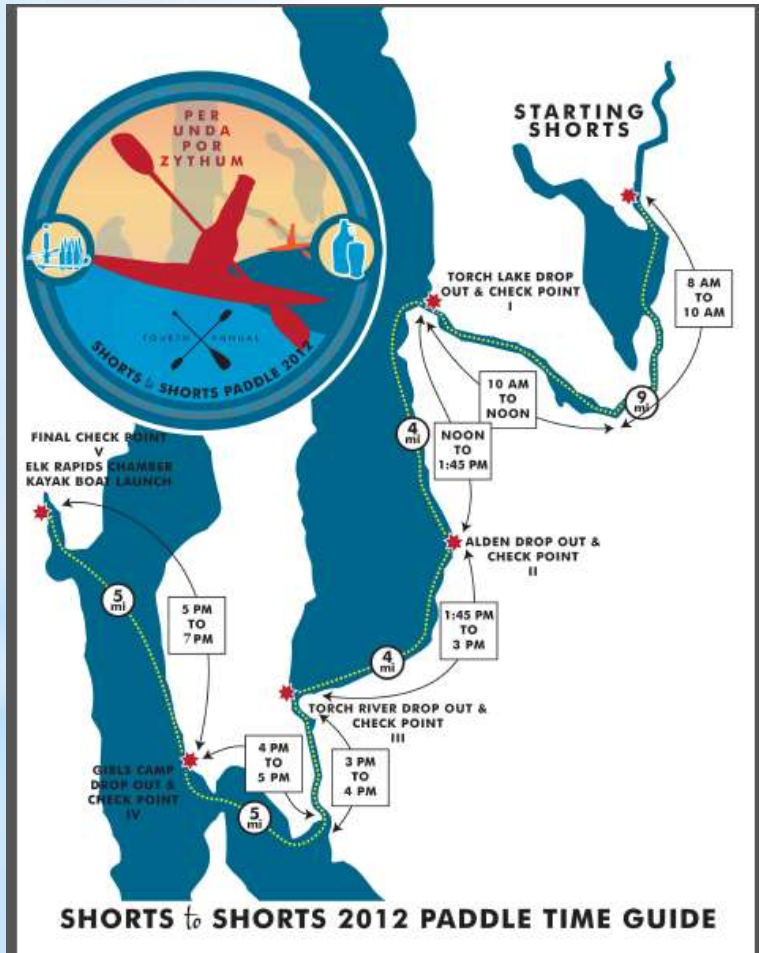

Cass River Water Trail Clean-up

community support



Fenton River Fest

A FUNdraiser set to help raise money for the many activities and events the "Keepers" hold, including (but not limited to) the annual River Clean-Ups, Water Quality Monitoring, constructing launches for kayaks and canoes, Moon light Paddles and more!!

JUNE 28

12PM-6PM | BUSH PARK

50/50 RAFFLE
RUBBER DUCKY RACE
**HOME-MADE CARDBOARD
CANOE/KAYAK REGATA**
FOOD • ART & CRAFT BOOTHS
LIVE LOCAL MUSIC

Keepers of the  Shiawassee

1st Flotilla - Linden





trail maintenance





planning



Access Site #1: T. North Pavilion

Status: Existing
Ownership: City of Vassar
Type: Natural
Parking: Large municipal lot
Existing Facilities: Rail Trail connection, restrooms, pavilion, grills, playground, basketball hoops, Farmer's Market, ice rink,



WHERE TO LOCATE LAUNCHES

Consider three the factors of stream site selection which is launch location. The first aspect is the shape of the stream, the bank, whether it is easy or steep. The second aspect is the shape of the stream and bottom. The third consideration is the location of the stream and whether it is a good place to launch.

Stream sites should be selected which are the best natural launch location in terms of required equipment, stream depth, and ease of access. A launch site should be particularly on a stream bank in the best launch location for a launch. Launches should be located on a stream bank in the best launch location for a launch. Launches should be located on a stream bank in the best launch location for a launch.

Figure 30-1

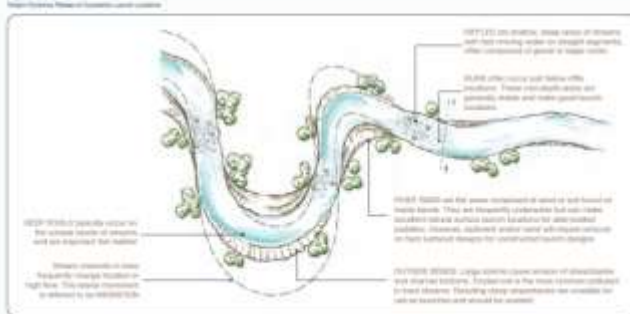







developing water trails IOWA SIGNAGE

Examine the photos, as well as the text, and find a successful building experience in Iowa trails. Examine the photos, as well as the text, and find a successful building experience in Iowa trails. Examine the photos, as well as the text, and find a successful building experience in Iowa trails.

10	1A Water Trails Signage
14	1B Low-Hurt Dam Signage
24	2C Signage Installation

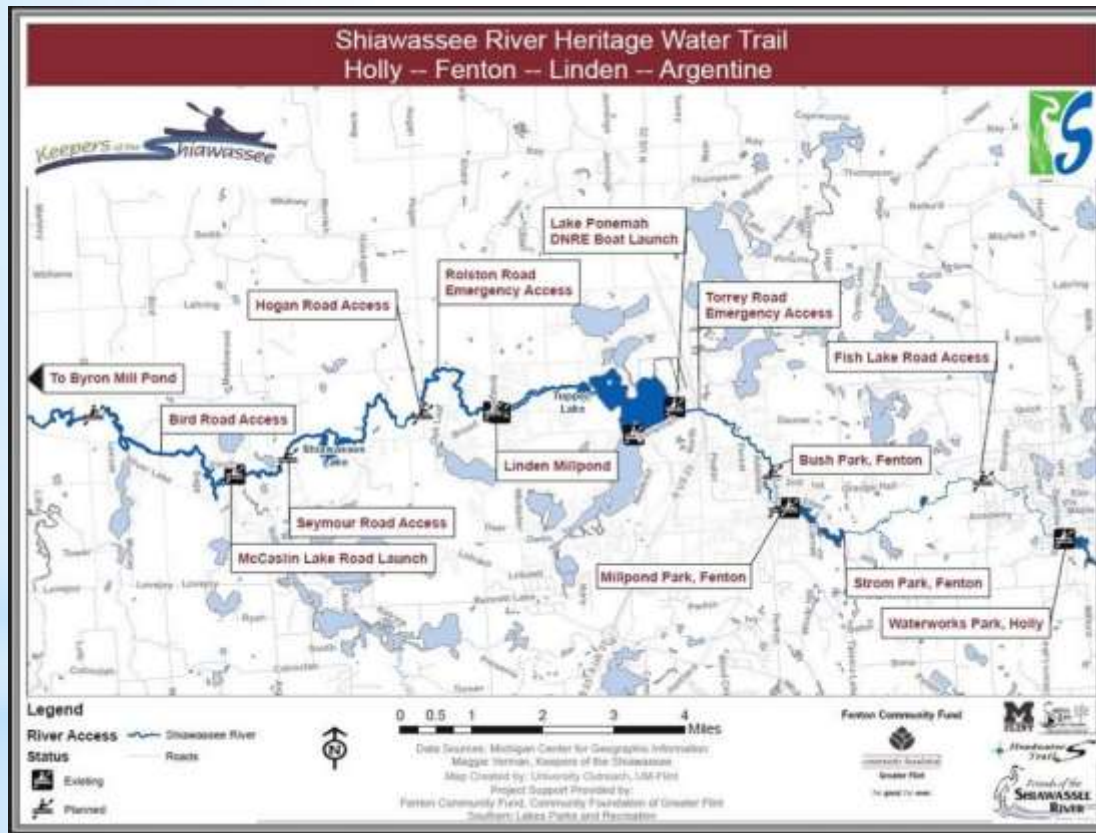
planning



Oak Rivers

MAXIMIZING OAKLAND COUNTY'S
RIVER CORRIDORS AS COMMUNITY
ASSETS

EXPLORATORY BLUEWAY WATER TRAIL
PROJECT

Shiawassee River: Holly to Fenton



Shiawassee River Heritage Water Trail

Exploring the Shiawassee River - by kayak and
paddle board

June 26, 2014

The river is growing in popularity



THE WILDER SIDE OF OAKLAND COUNTY

"Conserving the woods - fields, streams, wetlands and other natural resources in the headwaters of the Shiawassee and Huron rivers." - North Oakland Headwaters Land Conservancy (www.oak.org)



The North Oakland Headwaters Land Conservancy believes in conservation collaboration, and public awareness of the wilder side of Oakland County. Last October they sponsored a public paddle on the Shiawassee River. There is no better way to embrace the raw richness of the wild than to paddle it. From a canoe, kayak - or even a paddleboard. The scenic stretch of the Shiawassee that was paddled overgrown through meadows and woodlands and flows under train tracks and through suburbs only the rapids and even across over a small beaver dam as the journey from Holly to Fenton. It's an exciting adventure, for the Shiawassee River is as old as

How original and old that river is

Pages:

1. Shiawassee River Map (online)

2. Shiawassee River Map (print)

3. Shiawassee River Map (print)

4. Shiawassee River Map (print)

5. Shiawassee River Map (print)

6. Shiawassee River Map (print)

7. Shiawassee River Map (print)

8. Shiawassee River Map (print)

9. Shiawassee River Map (print)

10. Shiawassee River Map (print)

11. Shiawassee River Map (print)

12. Shiawassee River Map (print)

13. Shiawassee River Map (print)

14. Shiawassee River Map (print)

15. Shiawassee River Map (print)

16. Shiawassee River Map (print)

17. Shiawassee River Map (print)

18. Shiawassee River Map (print)

19. Shiawassee River Map (print)

20. Shiawassee River Map (print)

21. Shiawassee River Map (print)

22. Shiawassee River Map (print)

23. Shiawassee River Map (print)

24. Shiawassee River Map (print)

25. Shiawassee River Map (print)

26. Shiawassee River Map (print)

27. Shiawassee River Map (print)

28. Shiawassee River Map (print)

29. Shiawassee River Map (print)

30. Shiawassee River Map (print)

31. Shiawassee River Map (print)

32. Shiawassee River Map (print)

33. Shiawassee River Map (print)

34. Shiawassee River Map (print)

For More Information

- National Water Trail System

www.nps.gov/watertrails

- Toolbox

- NPS Rivers, Trails and Conservation Assistance Program www.nps.gov/rtca



Barbara_Nelson-Jameson@nps.gov